

## MR16 LED COLOURED GLOBES

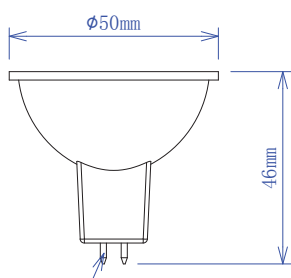

### Product Features:

- Input voltage: 12V
- Housing & diffuser: aluminium alloy & PC
- Wattage: 5W (=30W incandescent)
- Power factor: 0.8
- 10pcs SMD2835 LED chips
- MR16 lamp holder
- Ambient Temp: -10 to 40°C (The life of the lamp will gradually reduce if used outside these temperature parameters.)
- Suitable for 2-way switching
- Suitable for use with PIR sensor

NB: remote constant voltage DC control gear required

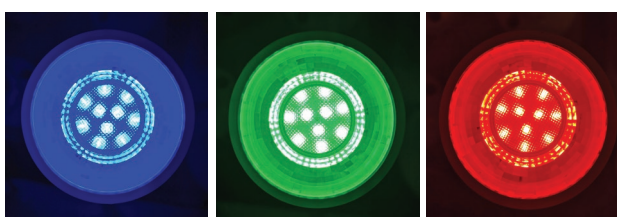

MR16B01

MR16G01

MR16R01

Part No.	Description	Kelvin (K)	Lumens (LM)	Watt (W)	CRI	Weight (kg)	Box (cm)	Carton QTY
MR16B01	GLOBE LED 12V AC/DC (White) MR16 5W BLUE	BLUE	65	5=30	N/A	0.05	6x5x5	200
MR16G01	GLOBE LED 12V AC/DC (White) MR16 5W GREEN	GREEN	50	5=30	N/A	0.05	6x5x5	200
MR16R01	GLOBE LED 12V AC/DC (White) MR16 5W RED	RED	50	5=30	N/A	0.05	6x5x5	200